

## Technical Data

KLUDI L STEEL  
Kitchen faucet

Ref.:  
45851F877

Finishes:  
F8 stainless steel hairline finish

Product description  
Manufacturer KLUDI GmbH & Co. KG  
Typ: KLUDI L STEEL  
Kitchen faucet  
Ref.: 45851F877

Kitchen faucet DN 15  
single lever mixer  
extractable spout  
single hole mounted  
solid lever, metal  
lateral actuation  
Aerator M18  
protected against back flow  
ceramic cartridge  
flow rate at 3 bar = 8 l/ min.  
swivel spout 180°  
flexible hoses G 3/8 DVGW approved  
shank-fixing  
extractable hoses M15 x 1500 mm

Product picture



Dimensional drawing

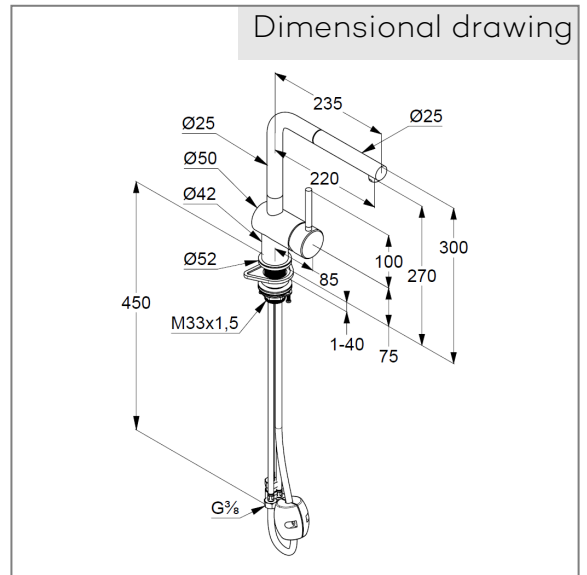

Flow rate diagram

